

Inflation Instructions

6" & 11" Balloons

Included Pieces

1 balloon (arrives flat)



1 stem



1 cup (2 halves)

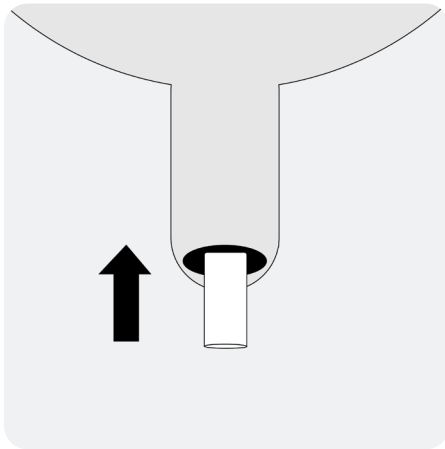

1 straw/support stick

Instructions**Step 1**

Begin by inserting the stem through the white tab at the bottom of the balloon. Leave about 1/16" of the stem outside of the balloon flap.

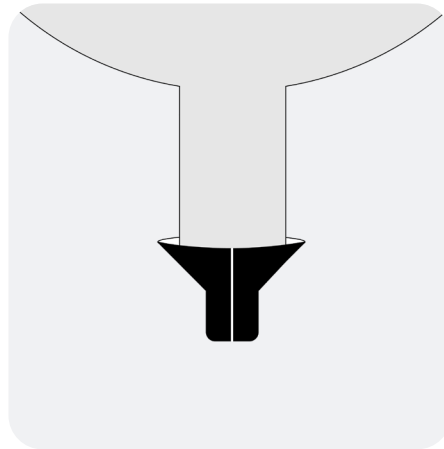
**Step 2**

Take the 2 cup halves and place them on either side of the stem – make sure the lip around the stem's center lines up with the grooves inside the cup halves. When properly aligned, the 2 halves should form a single cup.

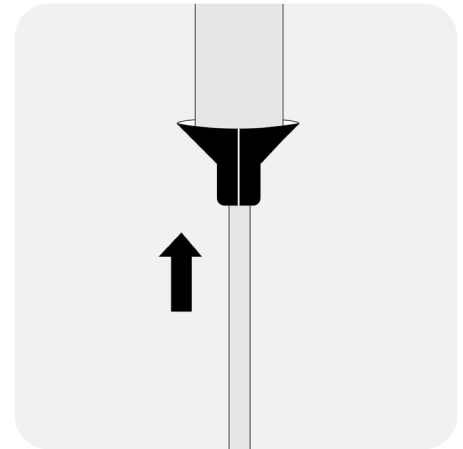
**Step 3**

Insert the straw over the end of the cup. Push the straw up while turning until the 2 halves are firmly held together.

**Step 4**

Slowly blow through the straw until the balloon completely inflates. The valve inside the balloon will automatically seal and remain sealed while you're blowing.

Note: You won't need to close the opening at the bottom of the straw.

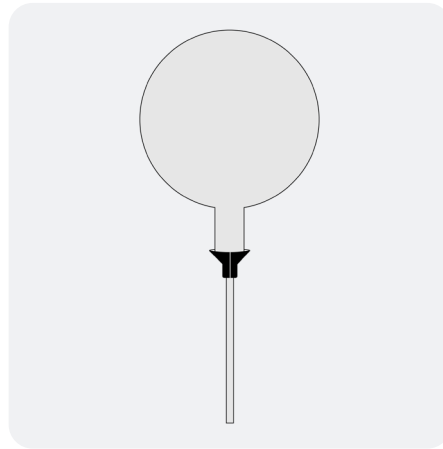
**Step 5**

Display and enjoy!

Note: With proper use and inflation, you can reinflate your balloons any time you like using the instructions above.

Do's & Don'ts

Do: Follow these instructions as written and contact us with any questions.

Do: Refer to the deflation instructions below when you're ready to deflate your balloons.

Don't: Use helium to inflate the 6" or 11" balloons.

Inflation Instructions**22" Balloons**

Our 22" balloons should be filled with helium. To inflate, you can take them to a local helium supplier such as a grocery store, party store or florist – many will inflate the balloons for you for a nominal fee. Check with your local businesses to see if they offer this service. You can also rent or purchase helium tanks at many party stores and event supply stores.

While inflating, the balloon's self-sealing valve will automatically close and remain sealed. Once it's completely inflated, you can then attach a string or ribbon.

The balloons' helium lasts approximately 5-7 days. When it's time to deflate them, you can do so using the instructions below.

Do's & Don'ts

Do: Follow these instructions as written and contact us with any questions.

Do: Refer to the deflation instructions below when you're ready to deflate your balloons.

Don't: Use regular air to inflate the 22" balloons.

Deflation Instructions

All Sizes

What You'll Need



1 coffee stirrer or thin straw

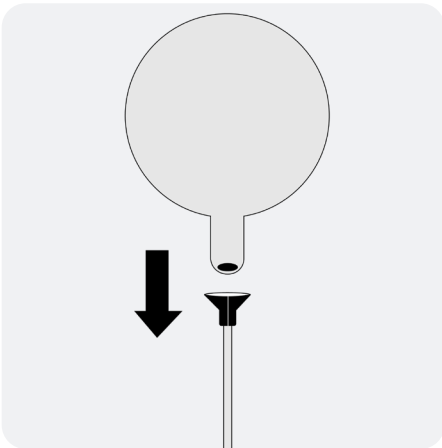

Step 1

Lay the balloon on a clean flat surface. If you're deflating the 6" or 11" balloon, remove the straw, cup halves and stem.

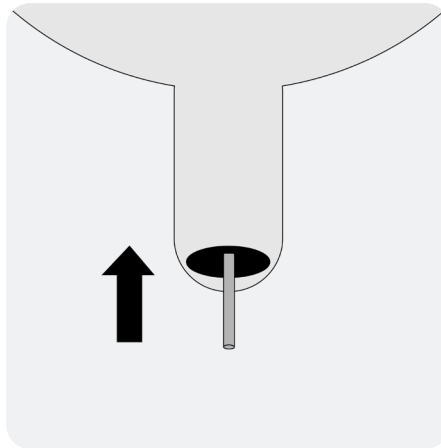

Step 2

Gently insert the coffee stirrer or thin straw into the white tab at the bottom of the balloon. Insert about 1 1/2" in until the air inside starts to release.

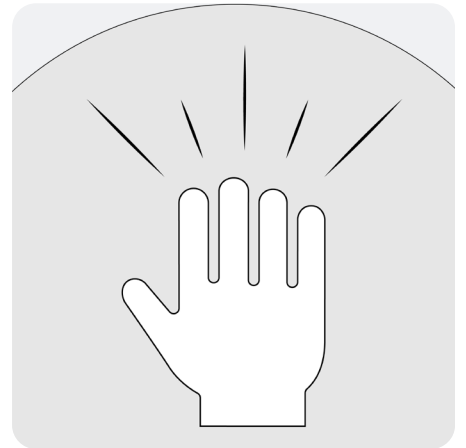

Step 3

Gently press down on the balloon with the palm of your hand until the balloon completely deflates.

Note: With proper use and inflation, you can reinflate your balloons any time you like using the instructions above.